

REVISIONS			
LTR	DESCRIPTION	DATE	APPROVED
NC	NEW RELEASE	06/18/09	MP
A	SEE DCN	10/05/09	MP
B	SEE DCN	02/11/10	MP
C	SEE DCN	10/11/10	MP

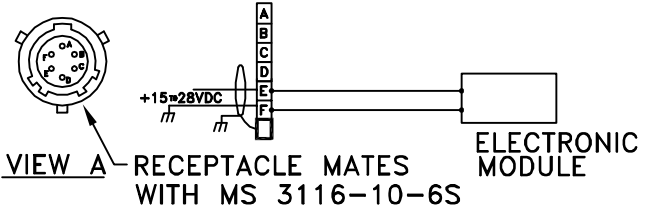
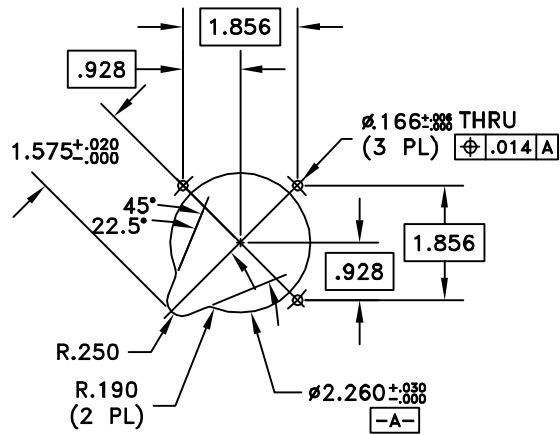
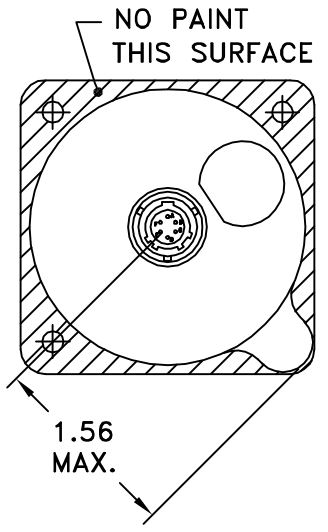
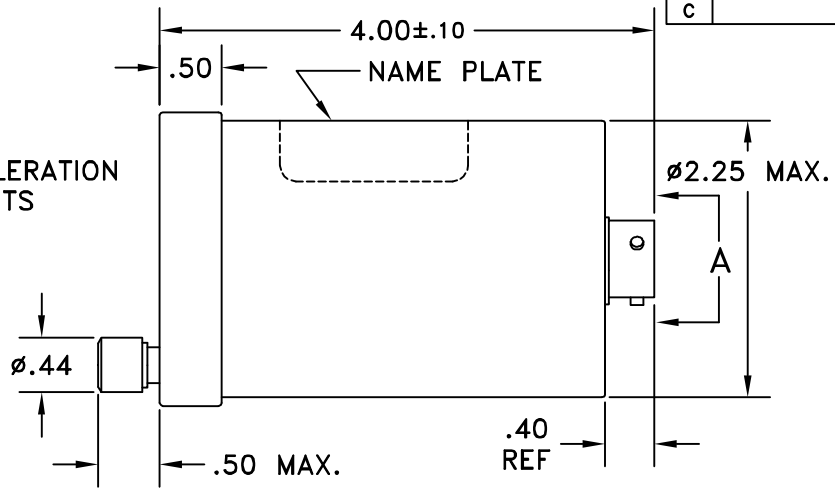
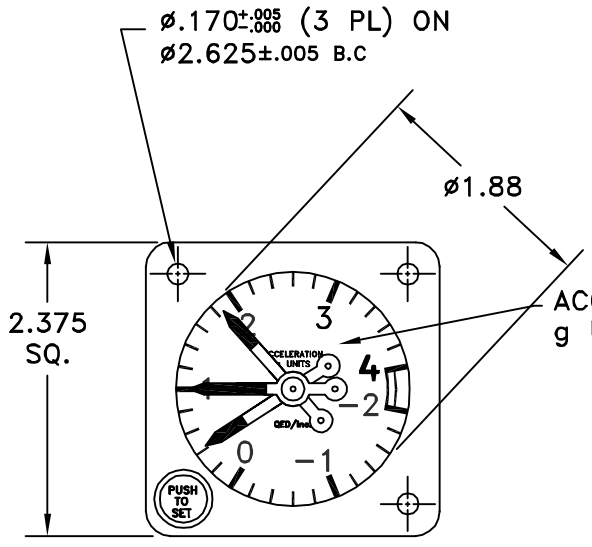

PANEL CUTOUT
SCALE: .5=1

EAR DOCUMENT
 THESE COMMERCIAL ITEMS ARE SUBJECT TO THE EXPORT CONTROLS OF THE U.S. GOVERNMENT, AND MAY NOT BE EXPORTED TO A FOREIGN PERSON WITHOUT THE WRITTEN APPROVAL OF THE U.S. DEPARTMENT OF COMMERCE.
 THIS DOCUMENT IS THE PROPERTY OF QED/INC. AND IS CONVEYED WITH THE EXPRESS CONDITION THAT IT AND THE INFORMATION CONTAINED IN IT ARE NOT TO BE USED, DISCLOSED, OR REPRODUCED IN WHOLE OR IN PART, FOR ANY PURPOSE WITHOUT THE EXPRESS WRITTEN CONSENT OF QED/INC., AND THAT NO RIGHT IS GRANTED TO DISCLOSE OR SO USE ANY INFORMATION CONTAINED IN SAID DOCUMENT.

NOTES
 1. PAINT DURABLE DULL BLACK REF. COLOR #37038 OF FED-STD-595. EXCEPT ON SURFACE INDICATED.

UNLESS OTHERWISE SPECIFIED DIMENSIONS ARE IN INCHES DECIMALS FRACTIONS .X ± .030 ± 5' .XX ± .030 ANGLES .XXX ± .010 ±	SIGNATURES	DATE	QED/inc. 2920 SOUTH HALLADAY STREET SANTA ANA, CALIFORNIA 92705	
	BY AFS	06/18/09	TITLE ACCELEROMETER ELECTRONIC/ANALOG	
MATL:	ENGR LMP	06/18/09	SIZE B	CODE IDENT NO. 24708
	APPD		DWG NO. 3004-10-500	
FINISH			SCALE 1:1	WT. SHEET 1 OF 2

REVISIONS			
LTR	DESCRIPTION	DATE	APPROVED

SPECIFICATIONS

1. RANGE: -2g TO +4g
2. THE SCALE ERROR FOR EACH READING IS NOT TO EXCEED $\pm 0.1g$ AT 20°C
3. INSTRUMENTATION: 15.0 TO 28.0 VDC .12 AMPS MAX.

MATERIALS

1. COVER GLASS: SHALL BE COATED WITH A REFLECTION REDUCING FILM IN ACCORDANCE WITH MIL-C-14806
2. DIAL TEXT SHALL BE FLAT WHITE: SIMILAR TO FED-STD-595 COLOR #37875, BACKGROUND SHALL BE BLACK; SIMILAR TO FED-STD-595 COLOR #37038
3. DIAL SHALL BE FINISHED IN A FLUORESCENT-LUMINESCENT MATERIAL IN ACCORDANCE WITH SPEC. MIL-L-25142, TYPE II; MARKINGS
4. MAIN POINTER: INDICATES REAL TIME ACCELERATION.
5. TWO AUXILIARY POINTERS ("TELL TALES"): ONE INDICATES MAX. POSITIVE ACCELERATION THE OTHER INDICATES MAX. NEGATIVE ACCELERATION BOTH PROVIDED WITH RATCHET LOCKING DEVICES ALLOWING MAX. INDICATIONS TO BE MAINTAINED UNTIL THE RESET KNOB IS DEPRESSED TO RESET THE AUXILIARY POINTERS
6. POINTER ENDS: FLUORESCENT PER MIL-L-25142, TYPE II

DESIGN CRITERIA

1. TEMPERATURE: -30°C TO +70°C
2. WEIGHT: 0.9 LBS MAX. (408 GRAMS)
3. TEST CONDITIONS- ALL VISUAL TESTS SHALL BE RESTRICTED TO THE UNAIDED EYE WITHIN A 60° CONE OF VISIBILITY AT A DISTANCE OF 18.0 \pm 2.0 INCHES, PER MIL-G-81704 PARA. 4.3.1.

DESIGN CRITERIA PER RTCA DO 160

DESCRIPTION	SECTION	CATEGORY
TEMPERATURE	4	A2
ALTITUDE	4	A2
TEMPERATURE VARIATION	5	C
OPERATIONAL SHOCKS	7	A
VIBRATION	8	R ZONE 2
MAGNETIC EFFECTS	15	Z
POWER INPUT	16	Z
VOLTAGE SPIKES	17	A
AUDIO FREQUENCY CONDUCTED SUSCEPTIBILITY	18	B
INDUCED SIGNAL SUSCEPTIBILITY	19	Z
RF SUSCEPTIBILITY	20	T
EMISSION OF RF ENERGY	21	B
LIGHTNING INDUCED TRANSIENT SUSCEPTIBILITY	22	A3
ELECTROSTATIC DISCHARGE	25	AZZZ

UNLESS OTHERWISE SPECIFIED DIMENSIONS ARE IN INCHES DECIMALS FRACTIONS X ± ± .XX ± ± ANGLES .XXX ± ±	SIGNATURES		DATE	QED/inc. 2920 SOUTH HALLADAY STREET SANTA ANA, CALIFORNIA 92705
	BY	AFS	06/18/09	
MATL:	CKD			TITLE ACCELEROMETER ELECTRONIC/ANALOG
	ENGR	M. PRATT	06/18/09	
FINISH	APPD			SIZE B
				CODE IDENT NO. 24708
				DWG NO. 3004-10-500
				SCALE 1:1 WT. .9 LB MAX. SHEET 2 OF 2